

PARAMETER		DATA						UNITS				
Electrical Rating	Type	Dry Type Harmonic Treatment Isolation Transformer										
	Power	112.5						kVA				
	Frequency	60						Hz				
	Primary	600 (Nominal)						Volts				
	Primary Taps	2 x 2 ½ % FCAN, 2 x 2 ½ % FCBN						%				
	Secondary	208/120 (no load)						Volts				
	Phase Shift	0 (Primary/Secondary)						Degrees				
Load Compatibility	K13						K-Factor					
Construction	Connection	Primary: 3 Ph 3-Wire, Secondary: 3 Ph. 4 -Wire										
	Neutral Bus Rating	200% of Line Current										
	Type	Low Voltage, Dry										
	Coils	Copper, Braised Internal Connections										
	Core	3-Leg, Very Low Loss Grain Oriented Steel										
	Insulation Class	220 (UL Listed)										
	Insulation Impregnation / Properties	Nomex – 20 mil min. Primary/Secondary Epoxy Copolymer – Build > 2 mils @ 3.2 kV/mil (dielectric) H ₂ O absorption < 0.05%, Curing VOC < 1.65 lbs/gal.										
Losses	Linear Loading	no load	15%:	25%:	35%:	50%:	75%:	100%:	%			
	Watt Loss	222	265	342	462	733	1,489	2,791	Watts			
	Heat	757	904	1,167	1,576	2,501	5,080	9,523	BTU/hr			
Efficiency	Per NEMA TP-2 (35% Load)	98.8 (NEMA TP-1 requirement 98.2 %) (DOE 10 CFR Part 430 CSL 3 requirement 98.8 %)						%				
	Linear Loading	1/6:	98.4	1/4:	98.8	1/2:	98.7	3/4:	98.2	1/1:	97.5	
	Non-Linear (I THD~80%)	1/6:	98.3	1/4:	98.6	1/2:	98.3	3/4:	97.5	1/1:	96.5	
Operation	Temperature Rise	< 115 (full linear load)						°C				
	Excitation	1.118						Amps				
	Audible Noise	50 dB (per NEMA ST-20)						dBA				
	Ambient	40 °C (per ANSI C57.96-01.100)						°C				
B.I.L.	10						kV					
Harmonic Treatment	Transformer secondary System (common coupling)	Triplens: 3 rd , 9 th , 15 th 5 th , 7 th , 17 th and 19 th with complimentary 30 degree transformer										
Abnormal	Short Circuit	Primary	2,421 (Sym. O/P Short circuit)						Amps			
		Secondary	9,789 (Asymmetrical L-N/G Short Circuit)									
		Inrush	404 (typ. 3 cycle recovery)									
Impedance	+/- Sequence	Z:	4.8	X:	4.3	R:	2.0	%				
		Zero Sequence	Z ₀ :	0.98	X ₀ :	0.30	R ₀ :		0.94			
Mechanical	Enclosure	Type	NEMA 3R – Vermin resistant with < ½” wide openings									
		Finish	Green Epoxy Powder Coating									
	Drawing	C-Case / 300-000068-403 (attached)										
		Weight	975						lbs			
Standards	ISO Certifications		ISO 9001-2000: Quality Management System ISO 14001-2004: Environmental Management System									
	UL/CSA / Specifications		UL 1561 Listed, CSA C22.2 No. 47-M90 Certified, NEMA ST-20									
Options: (Supplied only when marked with 'X')	X	Electrostatic Shield	> 60 (CM Attenuation @ 10kHz)						dB			
		Thermal Sensors	N.C. Dry Contacts @ 170 °C & 200 °C									
		TVSS	Surge Protection									
		SMART-1	Monitoring Port									



a division of International Innovative Systems
(800) 853-8265 (705) 759-4862

DATA SHEET

MODEL:

HMT-C3 -112.5-0-600-208

Prepared: N.Xie Date: 10 Dec 08 Doc. No: 200-002503-800 Part No: 200-002503-100

Approved: Date: Rev. Date: 10 Dec 08 By: N.Xie Rev: A01

REV	ECO No.	DESCRIPTION
A00		RELEASED
A01		ADDED -3R SIDE VIEW
A02		ADDED SUGGESTED DIMENSIONS FOR SIDE PANEL ACCESS

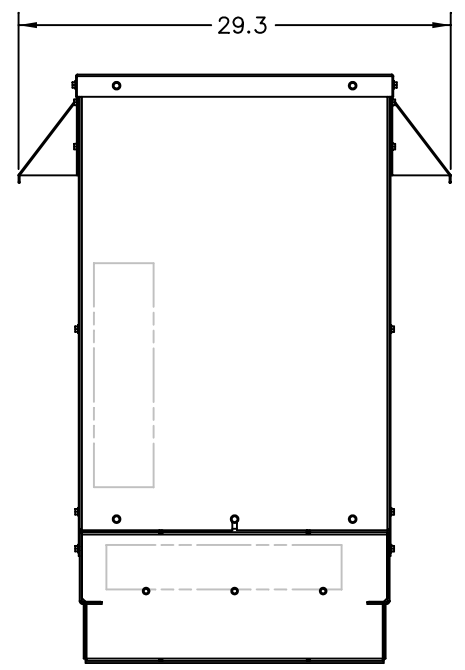
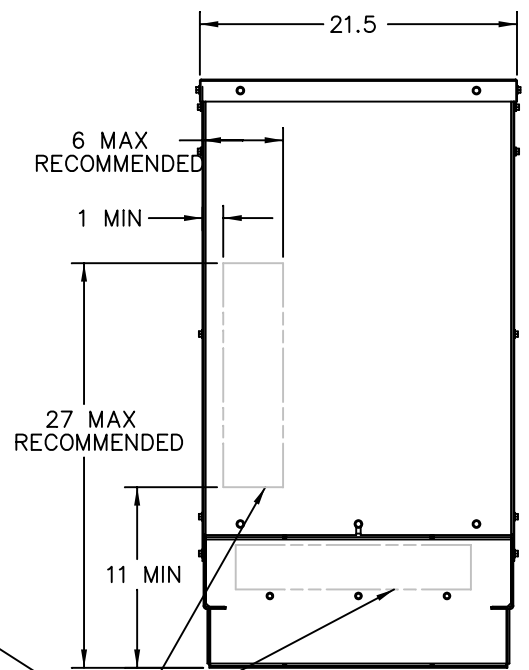
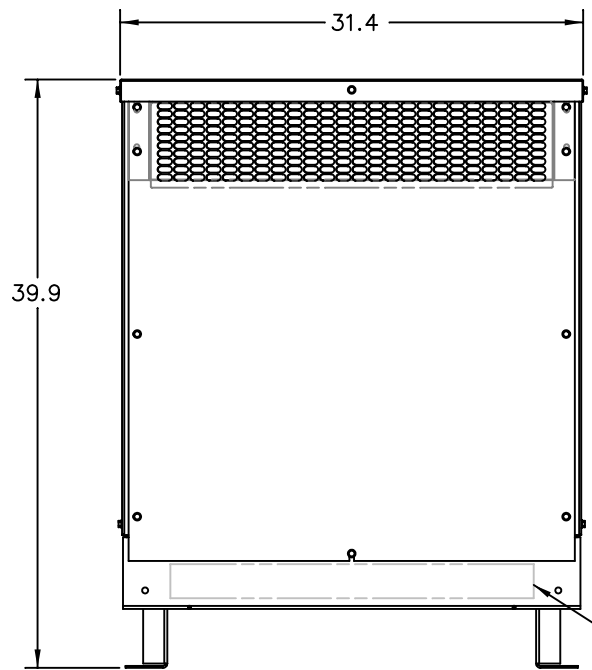

CONDUIT ACCESS

NEMA TYPE-1 (STANDARD)

NEMA TYPE-3R (OPTION WHEN SPECIFIED)
NOTE: RAIN SHIELDS INSTALLED AT SITE

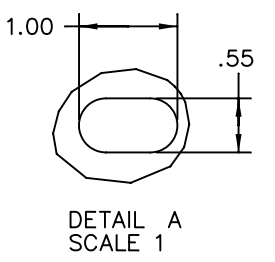
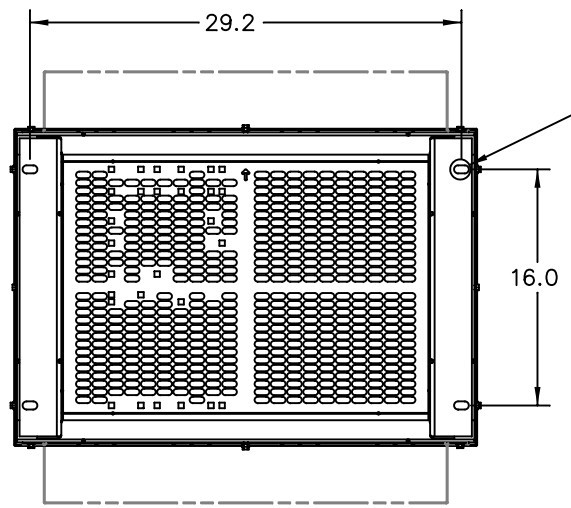

UNLESS OTHERWISE SPECIFIED, DIMENSIONS ARE IN INCHES.		BY	DATE	E-FACTOR
TOLERANCES ARE:		APPROVED	DT 08-Sep-01	
1-PLACE DECIMAL	: ± .03	mm	± .8	TITLE OUTLINE, C CASE
2-PLACE DECIMAL	: ± .010		± .25	
3-PLACE DECIMAL	: ± .005		± .10	
ANGULAR	: ± 1/2°		± 1/2°	
SURFACE FINISH : 125 ✓		APPROVED		
MATERIAL		APPROVED		
FINISH		UNLESS OTHERWISE NOTED REMOVE ALL BURRS AND SHARP EDGES		DRAWING NO. 300-000068-403
DO NOT SCALE DRAWING		REF:	SHEET	REV. A02
			1	of 1