

PARAMETER		DATA						UNITS				
<b>Electrical Rating</b>	Type	Dry Type, Harmonic Treatment Isolation Transformer										
	Power	112.5						kVA				
	Frequency	60						Hz				
	Primary	600 (Nominal)						Volts				
	Primary Taps	2 x 2 ½ % FCAN, 2 x 2 ½ % FCBN						%				
	Secondary	208/120 (no load)						Volts				
	Phase Shift	30 (Primary/Secondary)						Degrees				
Load Compatibility	K13						K-Factor					
<b>Construction</b>	Connection	Primary: 3 Ph 3-Wire, Secondary: 3 Ph. 4 -Wire										
	Neutral Bus Rating	200% of Line Current										
	Type	Low Voltage, Dry										
	Coils	Copper, Braised Internal Connections										
	Core	3-Leg, Very Low Loss Grain Oriented Steel										
	Insulation Class	220 (UL Listed)										
	Insulation Impregnation / Properties	Nomex – 20 mil min. Primary/Secondary Epoxy Copolymer – Build > 2 mils @ 3.2 kV/mil (dielectric) H <sub>2</sub> O absorption < 0.05%, Curing VOC < 1.65 lbs/gal.										
<b>Losses</b>	Linear Loading	no load	15%:	25%:	35%:	50%:	75%:	100%:	%			
	Watt Loss	224	264	453	542	709	1,423	2,638	Watts			
	Heat	764	901	1,546	1,850	2,419	4,855	9,001	BTU/hr			
<b>Efficiency</b>	Per NEMA TP-2 (35% Load)	98.8 (NEMA TP-1 requirement 98.2 %) (DOE 10 CFR Part 430 CSL 3 requirement 98.8 %)						%				
	Linear Loading	1/6:	98.4	1/4:	98.8	1/2:	98.7	3/4:	98.3	1/1:	97.7	
	Non-Linear (I THD~80%)	1/6:	98.3	1/4:	98.6	1/2:	98.4	3/4:	97.7	1/1:	96.8	
<b>Operation</b>	Temperature Rise	< 115 (full linear load)						°C				
	Excitation	1.95						Amps				
	Audible Noise	50 dB (per NEMA ST-20)						dBA				
	Ambient	40 °C (per ANSI C57.96-01.100)						°C				
B.I.L.	10						kV					
<b>Harmonic Treatment</b>	Transformer secondary System (common coupling)	Triplens: 3 <sup>rd</sup> , 9 <sup>th</sup> , 15 <sup>th</sup> 5 <sup>th</sup> , 7 <sup>th</sup> , 17 <sup>th</sup> and 19 <sup>th</sup> with complimentary 0 degree transformer										
<b>Abnormal</b>	Short Circuit	Primary	2,406 (Sym. O/P Short circuit)					Amps				
		Secondary	9,717 (Asymmetrical L-N/G Short Circuit)									
	Inrush	406 (typ. 3 cycle recovery)										
<b>Impedance</b>	+/- Sequence	Z:	3.4	X:	2.8	R:	1.9	%				
		Zero Sequence	Z <sub>0</sub> :	0.95	X <sub>0</sub> :	0.11	R <sub>0</sub> :		0.94			
<b>Mechanical</b>	Enclosure	Type	N3R(Rain Shield) – Vermin resistant with < ½” wide openings									
		Finish	Green Epoxy Powder Coating									
	Drawing	C-Case / 300-000068-403 (attached)										
	Weight	975						lbs				
<b>Standards</b>	ISO Certifications	ISO 9001-2000: Quality Management System ISO 14001-2004: Environmental Management System										
	UL/CSA / Specifications	UL 1561 Listed, CSA C22.2 No. 47-M90 Certified, NEMA ST-20										
<b>Options: (Supplied only when marked with 'X')</b>	X	Electrostatic Shield	> 60 (CM Attenuation @ 1kHz)					dB				
		Thermal Sensors	N.C. Dry Contacts @ 170 °C & 200 °C									
		TVSS	Surge Protection									
		SMART-1	Monitoring Port									



a division of International Innovative Systems  
(800) 853-8265 (705) 759-4862

<b>DATA SHEET</b>	<b>MODEL: HMT-C3-112.5-30-600-208</b>				
Prepared: N.Xie	Date: 10 Dec 08	Doc. No: 200-002494-800	Part No: 200-002494-100		
Approved:	Date:	Rev. Date: 10 Dec 08	By: N.Xie	Rev: A01	

REV	ECO No.	DESCRIPTION
A00		RELEASED
A01		ADDED -3R SIDE VIEW
A02		ADDED SUGGESTED DIMENSIONS FOR SIDE PANEL ACCESS

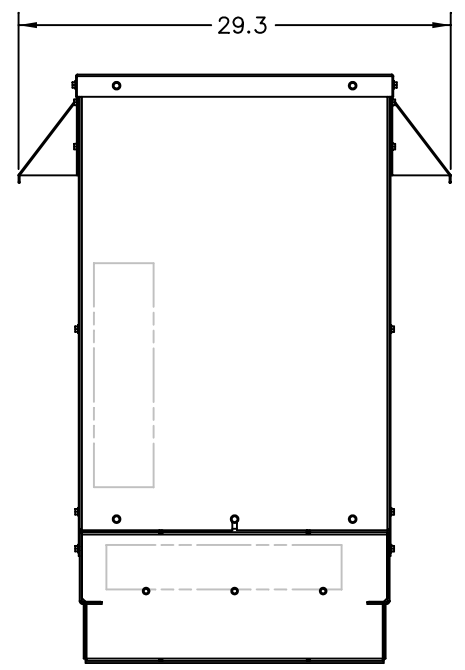
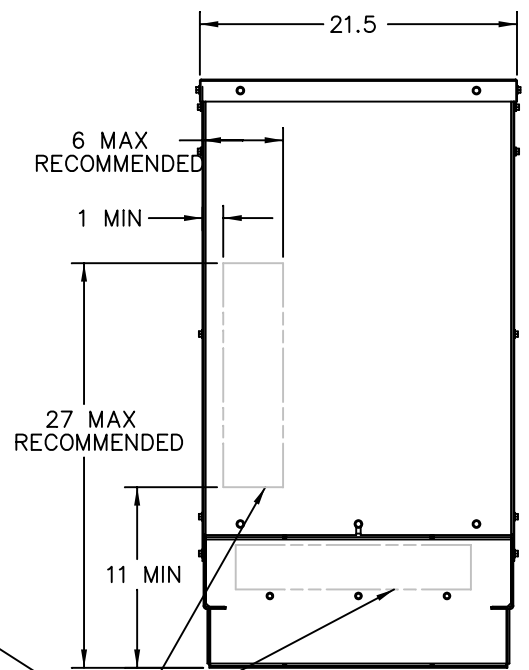
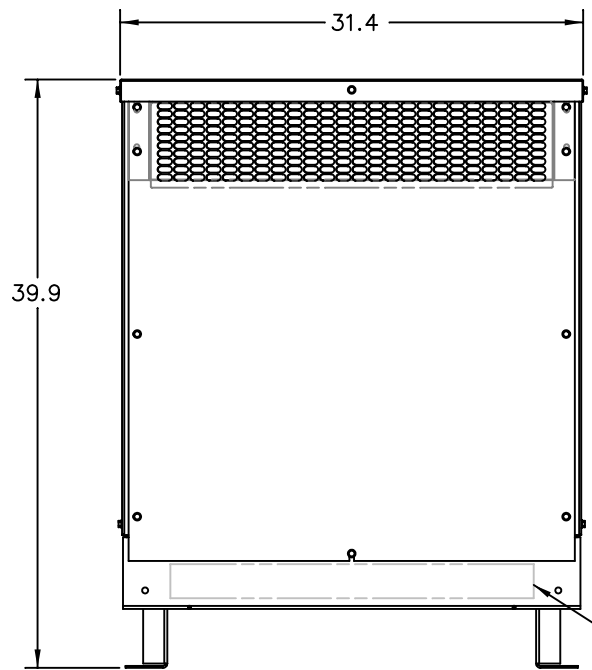

CONDUIT ACCESS

NEMA TYPE-1 (STANDARD)

NEMA TYPE-3R (OPTION WHEN SPECIFIED)  
NOTE: RAIN SHIELDS INSTALLED AT SITE

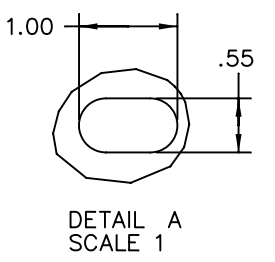
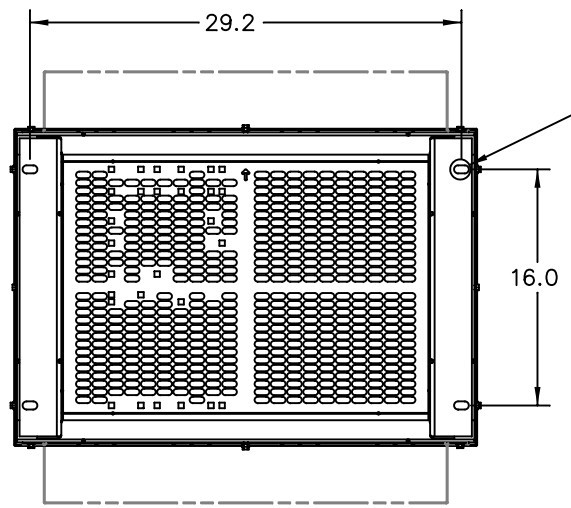

UNLESS OTHERWISE SPECIFIED, DIMENSIONS ARE IN INCHES.		BY	DATE	E-FACTOR
TOLERANCES ARE:		APPROVED	DT 08-Sep-01	
1-PLACE DECIMAL	: ± .03	mm	± .8	TITLE OUTLINE, C CASE
2-PLACE DECIMAL	: ± .010		± .25	
3-PLACE DECIMAL	: ± .005		± .10	
ANGULAR	: ± 1/2°		± 1/2°	
SURFACE FINISH : 125 ✓		APPROVED		
MATERIAL		APPROVED		
FINISH		UNLESS OTHERWISE NOTED REMOVE ALL BURRS AND SHARP EDGES		DRAWING NO. 300-000068-403
DO NOT SCALE DRAWING		REF:	SHEET	REV. A02
			1	of 1